

PACE **MACHINERY GROUP, INC.**

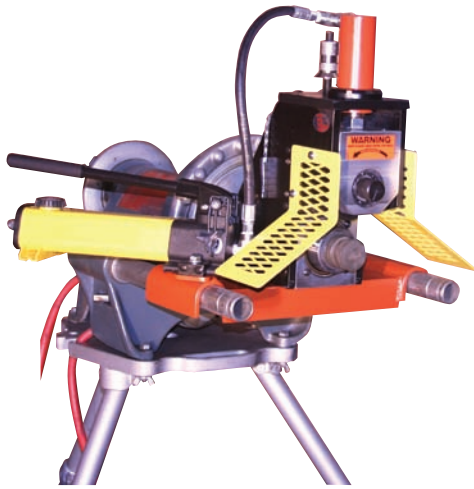

PIPE PROCESSING EQUIPMENT

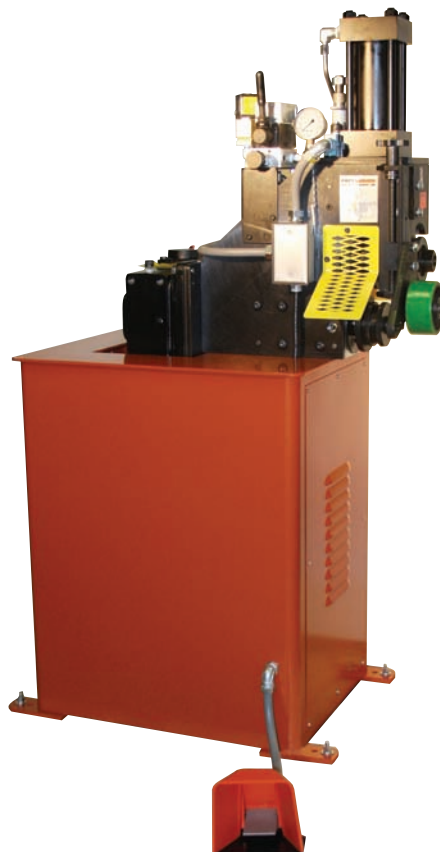

an introduction to PACE

We built our reputation as a manufacturer of tough, durable pipe grooving machinery for the fire protection, mining, paper, chemical and other industries. Pace Machinery is at work in virtually every developed country of the world, recognized as the most dependable and efficient equipment of its type.

As our customer base has grown, we have expanded the scope of the equipment we manufacture, so that now we can offer a complete line of machinery for roll grooving, cut grooving, drilling and buck-on machines.

Pace Pipe Processing Machines are built like fine machine tools. Every component has been carefully designed and machined to ensure efficient, trouble-free operation. Parts required to withstand high stress and torque are machined from special alloy steels to provide the service for which these machines are noted. For example: Idler and Main Shafts—through which torque and pressure are transmitted—are precision machined from Vacuum Melt Aircraft Quality materials ... the rugged speed reducers used in many Pace machines have strength, capacity and service life far beyond need—further insurance that your PACE machine will stand up to the most severe service.

roll grooving specifications

Every PACE Roll Groover will produce grooves of extraordinary quality in a wide range of piping materials including aluminum, steel and stainless steel. Design of the machines is such that pipe is grooved to required depth—yet pipe flare is held to an absolute minimum. Grooves themselves are bottom-radiused—no sharp corners to weaken or damage pipe integrity. As a result, PACE-grooved pipe is easier to assemble and couple.

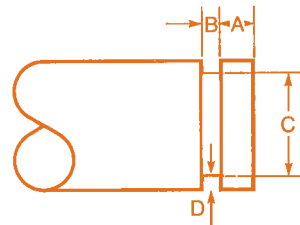

PIPE SIZE (IN.)	ACTUAL O.D. (IN.)	GASKET-SEAT A	ROLL GROOVE WIDTH (IN.)	PIPE SIZE (IN.)	PIPE SIZE (IN.)	PIPE SIZE (IN.)	ACTUAL O.D. (IN.)	GASKET-SEAT A	ROLL GROOVE WIDTH (IN.)	PIPE SIZE (IN.)	PIPE SIZE (IN.)
3/4	1.050	.625	.281	.938 + .000 - .015	.056	6	6.625	.625	.344	6.455 + .000 - .015	.085
1	1.315	.625	.281	1.190 + .000 - .015	.063	8	8.625	.750	.469	8.441 + .000 - .020	.092
1 1/4	1.660	.625	.281	1.535 + .000 - .015	.063	10	10.750	.750	.469	10.562 + .000 - .025	.094
1 1/2	1.900	.625	.281	1.775 + .000 - .015	.063	12	12.750	.750	.469	12.531 + .000 - .025	.109
2	2.375	.625	.344	2.250 + .000 - .015	.063	14 O.D.	14.000	.938	.469	13.781 + .000 - .025	.109
2 1/2	2.875	.625	.344	2.720 + .000 - .015	.078	16 O.D.	16.000	.938	.469	15.781 + .000 - .025	.109
3	3.500	.625	.344	3.344 + .000 - .015	.078	18 O.D.	18.000	1.000	.469	17.781 + .000 - .025	.109
3 1/2	4.000	.625	.344	3.834 + .000 - .015	.083	20 O.D.	20.000	1.000	.469	19.781 + .000 - .025	.109
4	4.500	.625	.344	4.334 + .000 - .015	.083	22 O.D.	22.000	1.000	.500	21.656 + .000 - .025	.172
5	5.563	.625	.344	5.395 + .000 - .015	.084	24 O.D.	24.000	1.000	.500	23.656 + .000 - .025	.172

model 1023

PORTABLE ROLL GROOVER

Capacity: 1 1/4" through 24" (32-610mm)

Portable Pipe Groover has been designed with a heavy-duty, high-efficiency gear reducer. The helical inline gear reducer with only five percent energy loss, will allow pipe grooving 1 1/4" through 24" with a 110 volt electrical service. Hand hydraulic pump applies up to 16,000 PSI at the point of roll grooving to produce accurate grooves for quick installation of pipe couplings. Use it at the job site or in the shop. Top and bottom rollers are easily interchanged to handle a wide range of pipe diameters.

MODEL 1023 SPECIFICATIONS

Capacity: 1 1/4" through 12" SCHD 40 (10mm)
12" through 24" Standard Wall .375 wall (9.5mm)
2" through 8" Copper Tubing K,L,M and DWV

Pipe Rotation Speed: 30 RPM

Hydraulic Pressure at Roller: 16,000 psi max.

Spindle Height from Floor: 33" (838mm)

Electric Drive Motor: 1 1/2 HP 60Hz 110 V 1 PH

Floor Space Required: 31 1/2" x 33 1/2" (800 x 857mm)

Shipping Weight: 430 lbs.



Interchangeable Rollers:

TOP PIPE DIAMETER

1 1/4" through 1 1/2" (32-38mm)
2" through 3 1/2" (51 -89mm)
4" through 6" (102-152mm)
8" through 12" (203-305mm)
14" through 16" (356-407mm)
18" through 24" (457-610mm)

BOTTOM PIPE DIAMETER

1 1/4" through 1 1/2" (32-38mm)
2" through 3 1/2" (51-89mm)
4" through 6" (102-152mm)
8" through 12" (203-305mm)
14" through 16" (356-407mm)
18" through 24" (457-610mm)

STANDARD EQUIPMENT

Electric Motor • Groove Depth Gauge • Hydraulic Hand Pump •
Shipping /Storage Box • Rolls As Specified In Price List •
Guards • Foot Switch

OPTIONAL: Top and Bottom 2-8" copper tube grooving roll set.
Bottom 2-24" 10 Gauge stainless steel rolls.Top and Bottom 2-12"
flush seal gasket roll sets. Pipe Nipple/Stabilizer Bracket,
Mounting Feet.

model 2021

AUTOMATED ROLL GROOVER

Capacity: 1 1/4" through 24" (32-610 mm)

You can groove a lot of pipe in a wide range of diameters with this model because the operator merely pushes a button to get the job done. Six easily interchanged Top and Bottom Rollers give model 2021 the versatility to meet virtually any piping system requirement. The self-contained hydraulic system provides up to 16,000 psi pressure at the point of roll grooving. Hydraulic pressure is adjustable to provide optimum grooving efficiency for all diameters and wall thicknesses within the machine's range. Model 2021 is shipped completely assembled with Top and Bottom Rollers 4" through 6" installed on the machine.

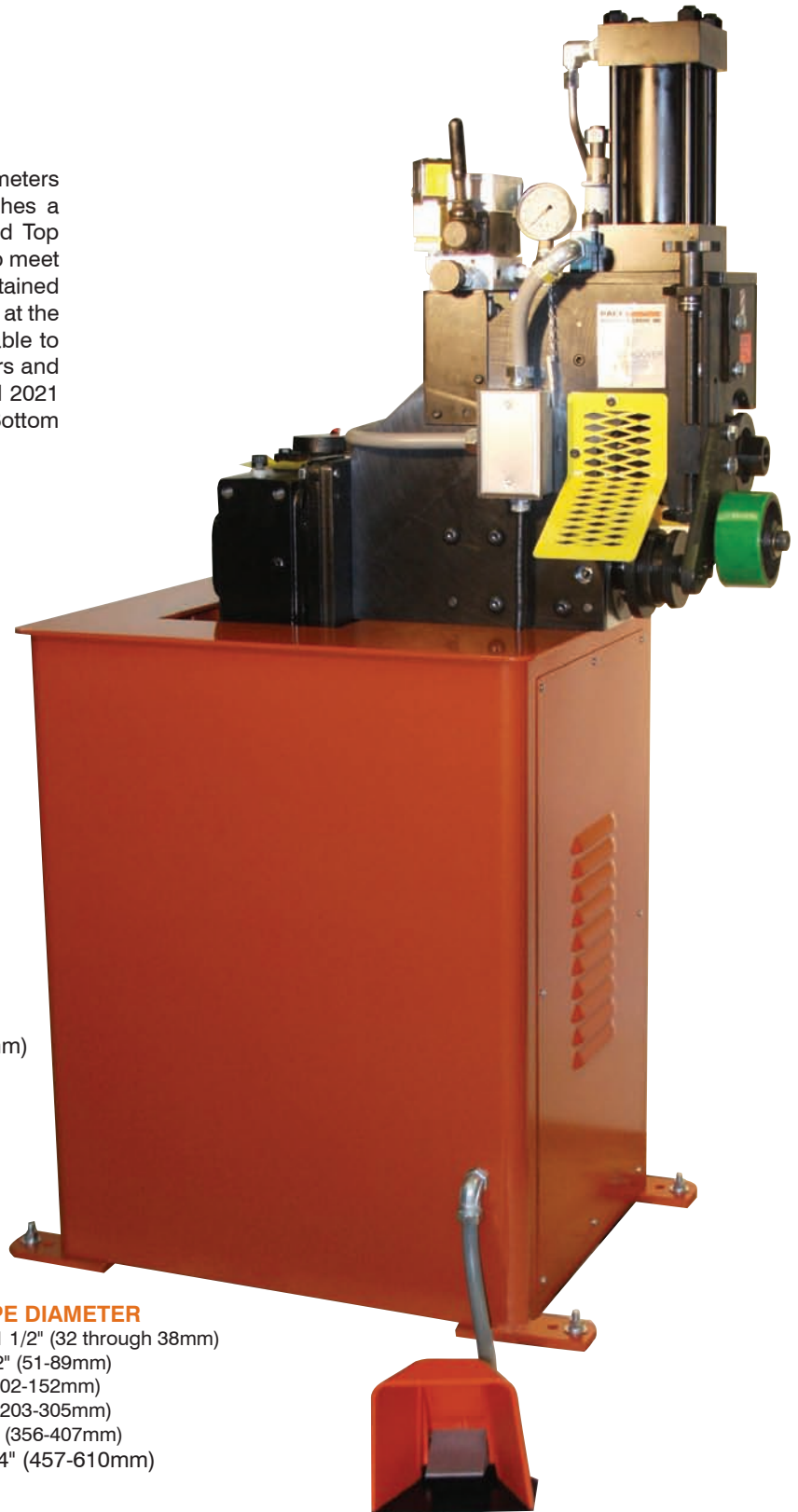

MODEL 2021 SPECIFICATIONS

Capacity: 1 1/4" through 12" SCHD 40 (10mm)
12" through 24" Standard Wall .375 (9.5mm)

Pipe Rotation Speed: 30 RPM

Hydraulic Pressure at Roller: 16,000 psi max.

Spindle Height from Floor: 33" (838mm)

Electric Drive Motor: 3 HP 60 Hz 220 V.3 PH.*

Hydraulic Pump Motor: 1 HP 60 Hz 220 V.3 PH.

Floor Space Required: 30" x 22" (762 x 559mm)

Shipping Weight: 775 lbs. (351.5 kgs)

Interchangeable Rollers:

TOP PIPE DIAMETER

1 1/4" through 1 1/2" (32 through 38mm)
2" through 3 1/2" (51-89mm)
4" through 6" (102-152mm)
8" through 12" (203-305mm)
14" through 16" (356-407mm)
18" through 24" (457-610mm)

*Other current characteristics available

BOTTOM PIPE DIAMETER

1 1/4" through 1 1/2" (32 through 38mm)
2" through 3 1/2" (51-89mm)
4" through 6" (102-152mm)
8" through 12" (203-305mm)
14" through 16" (356-407mm)
18" through 24" (457-610mm)

STANDARD EQUIPMENT

Electric Drive Motor • Limit Switch for Depth Gauging • Groove Depth Gauge • Hydraulic Pump • Model 4037 Nipple Bracket • Rolls As Specified In Price List • Guards • Foot Switch

OPTIONAL: Top and Bottom 2-8" copper tube grooving roll set. Bottom 2-24" 10 Gauge stainless steel rolls. Top and Bottom 2-12" flush seal gasket roll sets.



model 1112

PORTABLE ROLL GROOVER

Capacity: 1" through 12" pipe (25-305mm) Schedule 40

Model 1112 requires just three Top Rollers and three Bottom Rollers to produce specification quality grooves in pipe from 1" through 12" diameter Schedule 40. Easily portable for on-the-job work, the Model 1112's electric motor rotates pipe at speeds of 35 RPM. The hand hydraulic pump will deliver up to 15,000 psi pressure at the point of roll grooving. Like all PACE Pipe Grooving Machines, Model 1112 is ruggedly built to deliver long, trouble-free service.

MODEL 1112 SPECIFICATIONS

Capacity: 1" through 12" SCHD 40 (10mm)
2" through 8" Copper Tubing K,L,M and DWV

Pipe Rotation Speed: 35 RPM

Hydraulic Pressure at Roller: 15,000 psi max.

Spindle Height from Floor: 35" (889mm)

Electric Drive Motor: 1 1/2 HP 60Hz 110 V 1 PH

Floor Space Required: 32" x 32" (813x813 mm)

Shipping Weight: 220 lbs. (100kg)

Interchangeable Rollers:

TOP PIPE DIAMETER

1" through 1 1/2" (25-38mm)

2" through 6" (51-152mm)

8" through 12" (203-305mm)

BOTTOM PIPE DIAMETER

1" through 1 1/2" (25-38mm)

2" through 6" (51-152mm)

8" through 12" (203-305mm)

*Other current characteristics available

STANDARD EQUIPMENT

Electric Drive Motor • Groove Depth Gauge • Hydraulic Hand Pump • Top and Bottom Rollers 1-12" • Shipping/Storage Box • Guards • Foot Switch

OPTIONAL: Top and Bottom 2-8" copper tube grooving roll sets, Bottom 2-12" 10 Gauge stainless steel bottom rolls



model 2112

AUTOMATED ROLL GROOVER

Capacity: 1" through 12" pipe (25-305mm) Schedule 40

Model 2112 is a full power version of the Model 1112 and includes a self contained hydraulic system capable of applying 15,000 lbs. of pressure at the point of roll grooving to handle pipe up to 12" diameter Schedule 40. The hydraulic pump, 1 HP pump motor and reservoir are housed in the unit's sturdy steel base. Once the Automatic Depth Stop is set, the operator depresses a foot switch and the machine rolls the groove to the predetermined depth. Moving the Pressure Release Handle retracts the hydraulically powered Ram so the operator can remove and check the groove. Model 2112 is shipped completely assembled.

MODEL 2112 SPECIFICATIONS

Capacity: 1" through 12" SCHD 40 (10mm)
2" through 8" Copper Tubing K,L,M and DWV

Pipe Rotation Speed: 35 RPM

Hydraulic Pressure at Roller: 15,000 psi max.

Spindle Height from Floor: 35" (889mm)

Electric Drive Motor: 1 1/2 HP 60Hz 110 V 1 PH

Hydraulic Pump Motor: 1 HP 60 Hz 110V 1 PH

Floor Space Required: 30" x 22" (762x559mm)

Shipping Weight: 470 lbs. (213 kg)

Interchangeable Rollers:

TOP PIPE DIAMETER

1" through 1 1/2" (25-38mm)

2" through 6" (51-152mm)

8" through 12" (203-305mm)

BOTTOM PIPE DIAMETER

1" through 1 1/2" (25-38mm)

2" through 6" (51-152mm)

8" through 12" (203-305mm)

*Other current characteristics available

STANDARD EQUIPMENT

Electric Drive Motor • Limit Switch for depth gauging • Groove Depth Gauge • Hydraulic Pump Motor • Hydraulic Pump • Top and Bottom Rollers 1-12" • Guards • Foot Switch • Nipple Bracket

OPTIONAL: Top and Bottom 2-8" copper tube grooving roll sets, Bottom 2-12" 10 Gauge stainless steel bottom rolls.

model 1012

1"-12" SCHEDULE 40

PORTABLE ROLL GROOVER

When the ultimate is required in your grooving needs 1" thru 12" Schedule 40, the Pace model 1012 will answer those needs. This Pace design, with new hydraulic ratio along with advanced spindle design allows greater strength and pressure in a compact package for grooving up to 12" Schedule 40, using a standard model Ridgid® 300.

An hydraulic hand pump will deliver increased pressure for grooving up to .406 wall pipe to specification quality grooves. Top and bottom roll change is made easy with cross taper pin in the bottom roll and socket set screw in the top roll for positive no slip design. Like all Pace Roll Grooving tools, the model 1012 is rigidly designed for trouble free service.

MODEL 1012 SPECIFICATIONS

Capacity: 1" through 12" SCHD 40 (10mm)
2" through 8" Copper Tubing K,L,M and DWV

Shipping Weight: 125 lbs.

Interchangeable Rollers:

TOP PIPE DIAMETER

1" through 1 1/2" (25-38mm)
2" through 6" (51-152mm)
8" through 12" (203-305mm)

BOTTOM PIPE DIAMETER

1" through 1 1/2" (25-38mm)
2" through 6" (51-152mm)
8" through 12" (203-305mm)

STANDARD EQUIPMENT

Grooved Depth Gauge • Hydraulic Hand Pump •
Shipping/Storage Box • Rollers as specified in price list •
Pipe Nipple and Stabilizer Bracket • Guards

OPTIONAL: Top and Bottom 2-8" copper tube grooving roll sets, Bottom 2-12" 10 Gauge stainless steel bottom rolls



Model 1012 Roll Groover for Mounting on Ridgid® 300 Pipe Threader.

model 1022

PIPE GROOVER FOR MOUNTING ON

Ridgid® 300 PIPE THREADER

Capacity: 1 1/4" through 16" (42mm - 408mm)

Get double duty from the Ridgid® 300 Pipe Threader by converting it to a pipe groover with the Model 1022 Pipe Groover. Designed for quick, easy mounting on standard Model 300 the 1022 Pipe Groover can roll grooves in pipe from 1 1/4" to 16" diameter. The hand hydraulic pump will deliver up to 16,000 PSI pressure at the point of roll grooving; your Threader's motor will rotate the pipe to produce specification-quality grooves in pipe. Like all Pace Pipe Grooving machines, the Model 1022 is ruggedly built to deliver easy, trouble-free service.

MODEL 1022 SPECIFICATIONS

Capacity: 1 1/4" through 12" SCHD 40 (10mm)
12" through 16" Standard Wall .375 (9.5mm)
2" through 8" Copper Tubing K,L,M and DWV

Hydraulic Pressure at Roller: 16,000 psi max.

Shipping Weight: 285 lbs. (129.3 kg)

Interchangeable Rollers:

TOP PIPE DIAMETER

1 1/4" through 1 1/2" (32-38mm)
2" through 3 1/2" (51-89mm)
4" through 6" (102-152mm)
8" through 12" (203-305mm)
14" through 16" (356-407mm)

BOTTOM PIPE DIAMETER

1 1/4" through 1 1/2" (32-38mm)
2" through 3 1/2" (51-89mm)
4" through 6" (102-152mm)
8" through 12" (203-305mm)
14" through 16" (356-407mm)

STANDARD EQUIPMENT

Grooved Depth Gauge • Hydraulic Hand Pump • Rollers 1 1/4" through 16"
Shipping/Storage Box • Pipe Nipple and Stabilizer Bracket • Guards

OPTIONAL EQUIPMENT

Top and Bottom 2-8" copper tube grooving roll set. Bottom 2-24" 10 Gauge stainless steel rolls. Top and Bottom 2-12" flush seal gasket roll sets. Pipe Nipple/Stabilizer Bracket.

Mini-Mites - Service Tools of Choice

Roll groovers for handling the unexpected

Pace Mini-Mite roll groovers allow you to be sure you can handle anything when you get on the job site. They're handy, portable job-site tools that can save you hours of waiting for pipe to come back from the shop. Mini-Mites let you make quick adjustments no matter what obstacles are thrown in your way. New design has roller bearing front & back on main shaft.

model 1039

with ratchet hand crank, roll grooves 1 1/4" to 6" Schedule 40 or thin wall steel pipe on the scaffold or anywhere power is unavailable.

Capacity: 1 1/4" through 6" SCHD 40 (7mm)
2" through 8" Copper Tube K,L,M and DWV

The Pace 1039 Mini-Mite™ Roll groover service tool goes from in-place grooving and can be chucked in a Ridgid Model 300 in seconds with no gearbox removal. The Pace 1039 Mini-Mite™ is self-contained and can be entirely operated with its own multi-function crank so there are no other tools needed! All hex drives on the the Pace 1039 Mini-Mite™ are 15/16", so one wrench fits everything.

Mini-Mites require no modifications or parts changes to groove any pipe or tubing in their size range.

Each comes with multi-step depth gauge.

STANDARD EQUIPMENT: Ratchet with 15/16" deep socket

OPTIONAL: 2" Through 8" copper roll set



model 1039-66

Capacity: 2" through 8" Copper Tube K,L,M and DWV

STANDARD EQUIPMENT: Ratchet with 15/16" deep socket

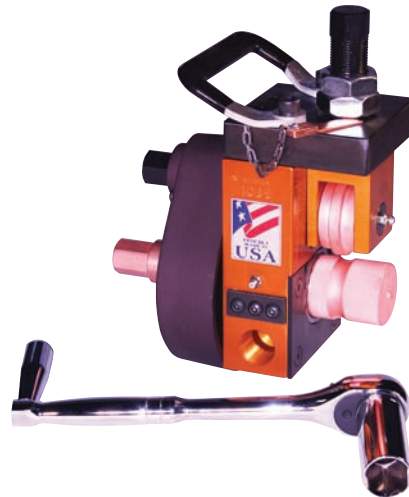

model 1039-812

Capacity: 8" through 12" Schedule 10

STANDARD EQUIPMENT: Ratchet with 15/16" deep socket



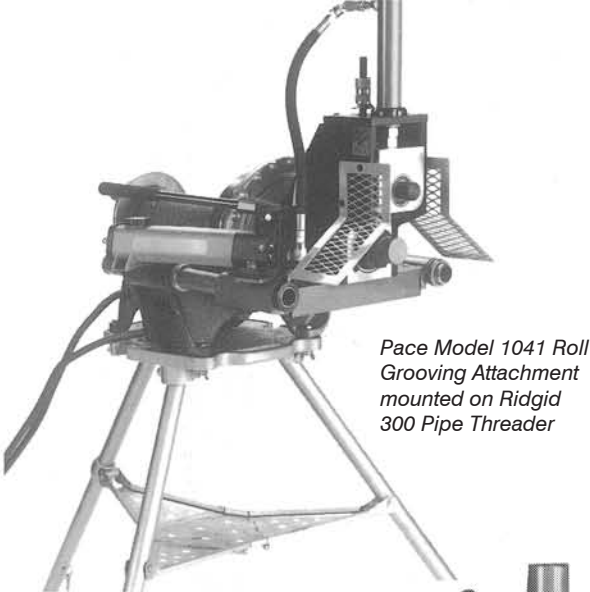

Pace Model 1041 Roll Grooving Attachment mounted on Ridgid 300 Pipe Threader

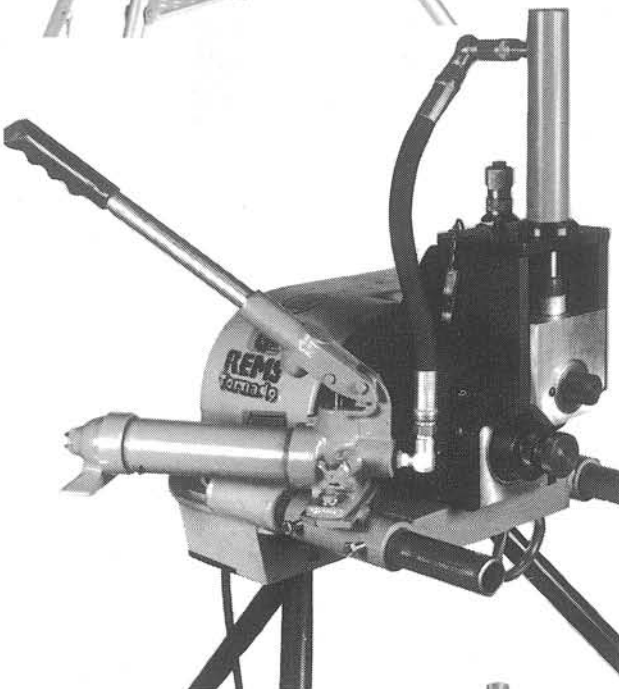

Pace Model 1043 Roll Grooving Attachment mounted on Ridgid 1224 Pipe Threader

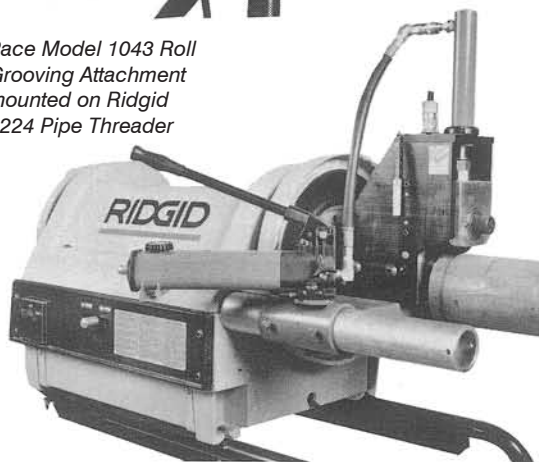

Size of pipe being grooved is easily set using calibrated depth gauge under flange of adjustable stop.

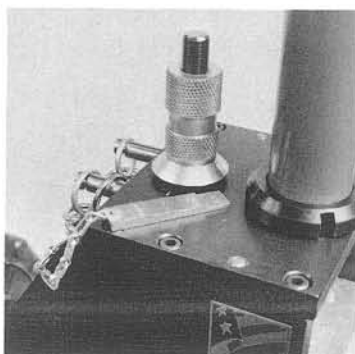

Pace Roll Grooving Attachments will double the utility of any power pipe threader by adapting it for production roll grooving. Built to deliver long, trouble-free service, these rugged machines mount in minutes without permanent modification to the threader, and can be removed just as quickly when the job is completed. The integral hydraulic hand pump will apply up to 8000 psi at the grooving roll, while the threader's motor rotates the pipe producing specification quality grooves. Shipped with safety guards.

model 1041

PIPE ROLL GROOVER ATTACHMENT FOR USE WITH Ridgid® 300 PIPE THREADER

- Quickly converts your Ridgid® 300 Threader to a production roll groover
- Mounts/dismounts easily on standard Model 300
- Capacity: 1" through 12" pipe (25-305mm)

MODEL 1041 SPECIFICATIONS

Capacity: 1" through 8" SCHD 40 (6mm)
1" through 12" SCHD 10 (5mm)
2" through 8" Copper Tubing K,L,M and DWV

Maximum Pressure at Roller: 8,000 psi

Shipping Weight: 94 lbs. (42.6 kg)

Interchangeable Rollers:

TOP PIPE DIAMETER

1" through 6" (25-152 mm)
8" through 12" (203-305mm)

BOTTOM PIPE DIAMETER

1" through 1 1/2" (25-38mm)
2" through 6" (51-152mm)
8" through 12" (203-305mm)

model 1042

PIPE ROLL GROOVING ATTACHMENT FOR USE WITH REMS GIGANT® AND TORNADO® PIPE THREADER

- Quickly converts your REMS GIGANT® or Tornado® threader to a production roll groover
- Mounts/dismounts easily on either machine
- Capacity: 1" through 6" pipe (25-152mm)

MODEL 1042 SPECIFICATIONS

Capacity: 1" through 8" SCHD 40 (6mm)
1" through 12" SCHD 10 (5mm)
2" through 8" Copper Tubing K,L,M and DWV

Maximum Pressure at Roller: 8,000 psi

Shipping Weight: 94 lbs. (42.6 kg)

Interchangeable Rollers:

TOP PIPE DIAMETER

1" through 6" (25-152mm)

BOTTOM PIPE DIAMETER

1" through 1 1/2" (25-38mm)
2" through 6" (51-152mm)

model 1043

PIPE ROLL GROOVING ATTACHMENT FOR USE WITH RIDGID® 1224 PIPE THREADER

- Quickly converts your Ridgid® 1224 Threader to a high production roll groover
- Mounts/dismounts easily on standard Model 1224
- Capacity: 1" through 12" (25-305mm)

MODEL 1043 SPECIFICATIONS

Capacity: 1" through 8" SCHD 40 (6mm)
1" through 12" SCHD 10 (5mm)
2" through 8" Copper Tubing K,L,M and DWV

Maximum Pressure at Roller: 8,000 psi

Shipping Weight: 98 lbs. (44.5 kg)

Interchangeable Rollers:

TOP PIPE DIAMETER

1" through 6" (25-152mm)
8" through 12" (203-305mm)

BOTTOM PIPE DIAMETER

1" through 1 1/2" (25-38mm)
2" through 6" (51-152mm)
8" through 12" (203-305mm)

model 1044

PIPE ROLL GROOVER ATTACHMENT FOR USE WITH Ridgid® 1822 PIPE THREADER

- Quickly converts your Ridgid® 1822 Threader to a production roll groover
- Mounts/dismounts easily on standard Model 1822
- Capacity: 1" through 6" pipe (25-152mm)

MODEL 1044 SPECIFICATIONS

Capacity: 1" through 6" SCHD 40 (6mm)
1" through 12" SCHD 10 (5mm)
2" through 8" Copper Tubing K,L,M and DWV

Maximum Pressure at Roller: 8,000 psi

Shipping Weight: 94 lbs. (42.6 kg)

Interchangeable Rollers:

TOP PIPE DIAMETER

1" through 6" (25-152 mm)

BOTTOM PIPE DIAMETER

1" through 1 1/2" (25-38mm)

2" through 6" (51-152mm)



Pace Model 1044 Roll Grooving Attachment mounted on Ridgid 1822 Pipe Threader

model 1045

PIPE ROLL GROOVING ATTACHMENT FOR USE WITH WHEELER-REX 6092 THREADER

- Quickly converts your Wheeler-Rex 6092 threader to a production roll groover
- Mounts/dismounts easily on standard Model 6092
- Capacity: 1" through 4" pipe (25-102mm)

MODEL 1045 SPECIFICATIONS

Capacity: 1" through 4" SCHD 40 (6mm)
1" through 4" SCHD 10 (5mm)
2" through 4" Copper Tubing K,L,M and DWV

Maximum Pressure at Roller: 8,000 psi

Shipping Weight: 94 lbs. (42.6 kg)

Interchangeable Rollers:

TOP PIPE DIAMETER

1" through 4" (25-102mm)

BOTTOM PIPE DIAMETER

1" through 1 1/2" (25-38mm)

2" through 4" (51-102mm)

Pace Model 1045 Roll Grooving Attachment mounted on Wheeler-Rex 6092 Pipe Threader

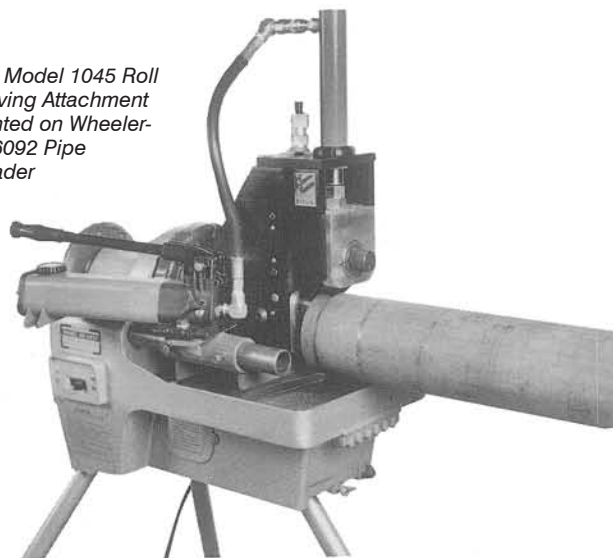

model 1046

PIPE ROLL GROOVING ATTACHMENT FOR USE WITH RIDGID® 535 PIPE THREADER

- Quickly converts your Ridgid® 535 Threader to a production roll groover
- Mounts/dismounts easily on standard Model 535
- Capacity: 1" through 6" (25-152mm))

MODEL 1046 SPECIFICATIONS

Capacity: 1" through 8" SCHD 40 (6mm)
1" through 12" SCHD 10 (5mm)
2" through 8" Copper Tubing K,L,M and DWV

Maximum Pressure at Roller: 8,000 psi

Shipping Weight: 104 lbs. (47 kg)

Interchangeable Rollers:

TOP PIPE DIAMETER

1" through 6" (25-152mm)

BOTTOM PIPE DIAMETER

1" through 1 1/2" (25-38mm)

2" through 6" (51-152mm)

Pace Model 1046 Roll Grooving Attachment mounted on Ridgid 535 Pipe Threader

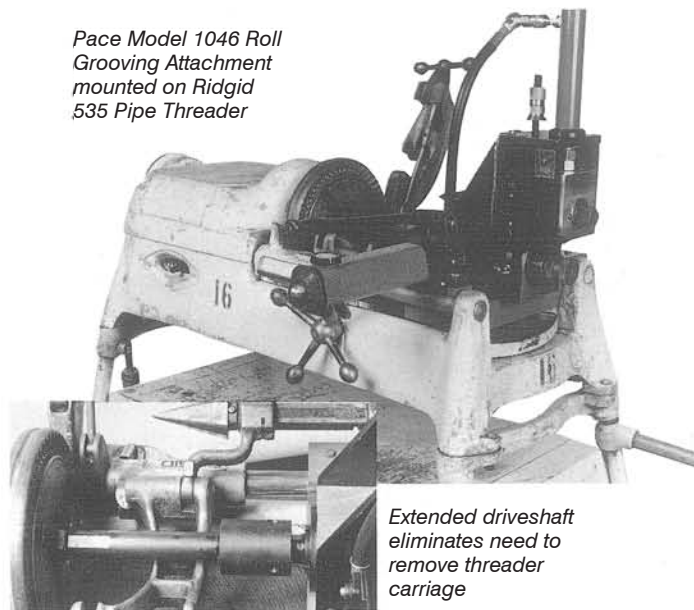

Extended driveshaft eliminates need to remove threader carriage

model 1047

PIPE ROLL GROOVING ATTACHMENT FOR USE WITH COLLINS® 22-A CAPACITY 1" - 12"

model 1048

PIPE ROLL GROOVING ATTACHMENT FOR USE WITH WHEELER-REX 6090 CAPACITY 1" - 6"

model 1049

PIPE ROLL GROOVING ATTACHMENT FOR USE WITH ROTHENBERGER® SM300 CAPACITY 1" - 12"

model 2050

AUTOMATED ROLL GROOVER

Capacity: 4" through 30" Pipe (101.6-762mm) Pipe

Wide capacity, high production automated Pipe Groover with a fully automatic hydraulic system permits roiling specification-quality grooves in one operation. Push-button controls and easy pipe loading insure high output. A 5 HP motor rotates even largest diameter pipe under the Top Roller which is under hydraulic pressure. Model 2050 is designed for specialty shops and contractors doing a large volume of pipe work. Five Top and Five Bottom Rollers are required to handle the full range of the machine's 4" (101.6mm) through 30" (762mm) capacity. Shipped completely assembled with Rollers.

MODEL 2050 SPECIFICATIONS

Capacity: 4" through 12" SCHD 40 (10mm)
12" through 30" Standard Wall .375 (9.5mm)

Pipe Rotation Speed: 30 RPM

Hydraulic Pressure at Roller: 20,000 psi max.

Spindle Height from Floor: 36" (914mm)

Electric Drive Motor: 5 HP 60 Hz 220 V.3PH

Hydraulic Pump Motor: 2 HP 60 Hz 220 V.3PH

Floor Space Required: 40" x 36" (1016 x 914.4mm)

Shipping Weight: 1500 lbs. (680 kgs)

Interchangeable Rollers:

TOP PIPE DIAMETER

4" through 6" (101.6-152.4mm)

8" through 12" (203.2-304.8mm)

14" through 16" (355.6-406.4mm)

18" through 24" (457.2-609.6mm)

26" through 30" (660.4-762mm)

*Also available in 50 cycle

BOTTOM PIPE DIAMETER

4" through 6" (101-152.4mm)

8" through 12" (203.2-304.5mm)

14" through 16" (355.6-406.4mm)

18" through 24" (457.2-609.6mm)

26" through 30" (660.4-762mm)

STANDARD EQUIPMENT

Electric Drive Motor • Limit switch for depth gauging
Groove Depth Gauge Hydraulic Pump Motor
Hydraulic Pump • Guards • Foot Switch



model 1000

PORTABLE CUT GROOVER

- Cuts grooves in 2, 2 1/2", 3, 3 1/2", 4, 5, 6 and 8" Schedule 40 pipe.
- Collet chucks for 10" and 12" pipe available
- Tooling for cut grooving ductile iron pipe also available
- Special collet chucks for non-standard dimension pipe can be supplied

The Pace Model 1000 is complete with 8 Collet Chucks, 4 High Speed Steel Grooving Blades and a Groove Gauge and is delivered ready to cut specification quality grooves in the complete 2" through 8" range of Schedule 40 pipe. Quick setups for each pipe size and simple operation make the Pace Model 1000 an extremely cost-effective tool for the fire protection and mechanical contractor. A 1 hp motor, driving through a heavy duty worm gear reducer, rotates pipe at 22 rpm for most effective cut grooving. Weighing only 185 lbs., Model 1000 is easily moved to the job.

MODEL 1000 SPECIFICATIONS

Capacity: 2" through 12" SCHD 40 (10mm)
2 1/2" through 8" SCHD 80 (13mm)

Power: 1 HP, 115-230V. Enclosed Single Phase Motor. Capacitor start. Output Speed 22 RPM.

Working Height: 38"

Weight: 185 lbs.

The Pace Pipe Cut Groover is shipped in a sturdy wooden box with storage area for individual collets, gauge and blades.

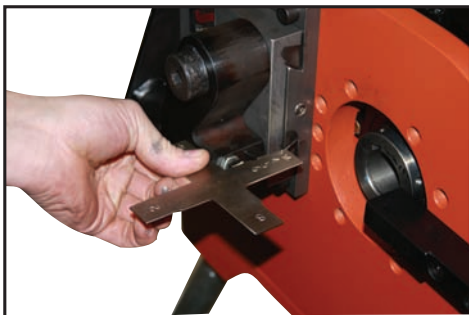

FAST, ACCURATE SET-UPS FOR EACH PIPE SIZE

Groove Gauge permits accurate adjustments of cutting blade and groove depth. Cutting blade is moved forward into contact with pipe by turning the handwheel. Large handwheel assures minimum effort.

Model 1000 will accept Collet Chucks up to 12". 4" diameter Chuck shown

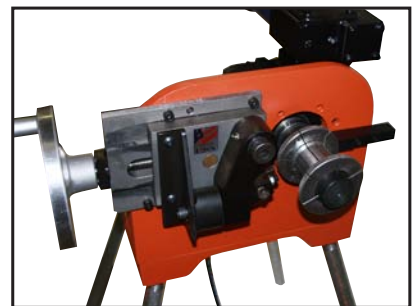

Pipe Stop (A) automatically locates position of groove to be cut. Adjustable Groove Depth Stop (B) automatically controls depth of cut.

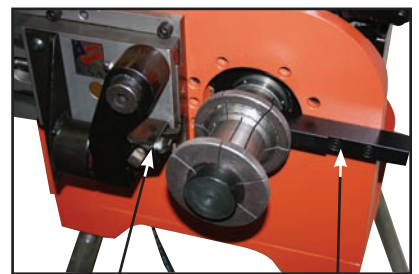

B

A



PIPE SUPPORT STANDS

Pipe support stands should always be used when rolling or cutting grooves in pipe. For cut grooving they are essential to keep the pipe level; for roll grooving, stands are adjusted to provide the slight downward pitch needed to keep the end of the pipe in firm contact with the back flange of the bottom roller. In every size range, Pace stands are made extra-rigid to prevent the "pendulum effect" which-with less sturdy stands-can whip the pipe off the support stand during a roll grooving operation.

model 4031

Capacity: 1" through 4" Pipe; 600 lbs. max.

A 22" diameter base and 2" column give this stand plenty of strength for supporting any pipe in its size range. The saddle has two roller bearings for free rotation of the pipe, and absorbs vibration to ensure a smooth, uniform groove. Saddle height is adjustable over a 10" (254mm) range.

The two-roller-bearing saddle may be ordered alone as **No. 4032**. Replacement roller bearing is **No. 4025**.

model 4000

Capacity: 2" through 8" Pipe; 900 lbs. max.

The base of this stand is the same as used in Model 4031, above. A saddle with four roller bearings provides greater side support for the pipe and increased dampening of vibration without impairing the unit's free-rolling characteristics. Saddle height is adjustable over a 10" (254mm) range.

The four-roller-bearing saddle may be ordered alone as **No. 4001**. Replacement roller bearing is **No. 4025**.



model 4033

Capacity: 2" through 14" Pipe; 1200 lbs. max.

This extra-heavy-duty pipe support stand uses two 2" columns on a 22" diameter base to give it exceptional stability and resistance to vibration and pendulum effect. Each column incorporates a sturdy, threaded post infinitely adjustable over a 10" (254 mm) range. The saddle utilizes six roller bearings in an array that provides excellent support for all pipes in its size range.

Replacement roller bearing is **No. 4025**.

model 4040

Capacity: 12"-24" Pipe; 4000 lbs. max.

This is our SuperStand! Fabricated of 6" diameter steel pipe welded to a 36" diameter base, this massive stand can support up to two tons of pipe during grooving operations. Pipe saddle height is adjustable over a 5" (127 mm) range.

model 4039

MOUNTING FEET

Fit Models 1000, 1010, 1020, 1021, 1023 and 1040 Portable Groovers. There are many situations where a portable groover will be employed in a single location long enough to make a semi-permanent installation desirable. By simply adding a set of these mounting feet and bolting the machine to the floor, the user gains some of the increased stability and rigidity typical of a stationary groover. When the work is completed, the unit can quickly and easily be disassembled and trucked to a new location.



model 4037

NIPPLE BRACKET

Capacity: 8" through 24" (203-610mm) Pipe. Fits Models 1020, 1021, 1023, 2020, 2021 and 2050 Roll Groovers

This nipple bracket was developed to permit safer, more efficient roll grooving of pipe too short to mount in a pipe stand. The plastic composition clamp-roller fixes pipe nipple in a controlled, slightly eccentric position so that the pipe is held firmly against the back flange of the bottom roller as it rotates. Pipe nipples as short as 6" can be grooved using this tool, permitting high production rates without the need for manual positioning by shop personnel.

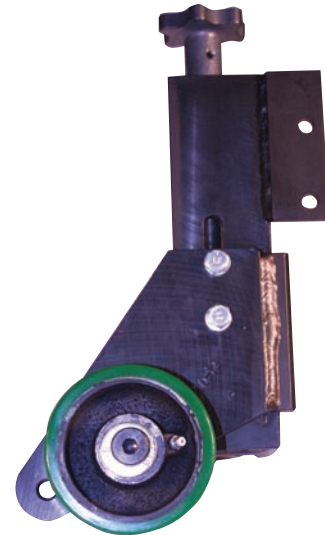

go / no-go gauges

Because they simulate a pipe coupling, Pace Go/No-Go Gauges are an excellent tool to use for quickly determining accuracy of groove depth. After a groove is rolled, the appropriate gauge is matched to it. If the gauge will not fit, the groove is too shallow; if the gauge slides past its No-Go marking, the groove is too deep. Made of steel and hard-chrome plated for durability, these gauges are easy to use and remain permanently accurate. Standard size gauges are made for groove diameters from 1" (25.4mm) to 12" (305mm). Other sizes can be furnished on request.



universal gauge

The Pace Universal Groove Gauge can accomplish many functions in only one tool. No other gauging tool can do as much. The primary job of this gauge is to check groove depth and tolerance from 2" thru 8", but goes on from there. Grooves can be checked while the pipe is on the machine. The groove can be checked while the grooving process is happening because of the very hard, heat treated wear surface and the spring loaded size bar. This is much easier than using a coupling half where you must remove the pipe to use. What if the coupling is not accurate? Chrome plated finish for high durability...a must for rougher use and long life. Think of Pace Tools and Machines for ease of use and durability.



model 3013

PORTA-BORE

Designed for fast, efficient operation, using Slugger® cutters, hole saws and drills

- Solid alloy aluminum construction. It is the most ruggedly constructed machine in the industry.
- Slide and gibbs are heat treated aluminum that is Teflon coated to insure long life. Slide assembly is positioned together by gauge block machining. This assembly is located by dowelled gibbs that are precisely aligned with the V-block. There are no elongated holes which could allow misalignment.
- Motor is a 10 Amp draw industrial drill motor with internal 4-speed gear box 110, 175, 245, 385 RPM. Spindle bore is a No. 3 Morse Taper.
- Electrical Panel meets the highest standard of operating safety. A Circuit Breaker assures no safety hazard to the operator or machine.
- Arbor support design for use with Slugger™ cutters, or drill chuck for use with hole saws or drills.
- Chain clamp is standard on all units and clamps to pipe diameters 1 1/4" through 12". *
- Optional speed toggle clamp, clamps 1 1/4" through 6" pipe.*

*Both clamps ensure positive holding during hole cutting operations and can be used in any position.

- Easy part replacement - building block design allows easy part repair or replacement. (No need to ship machine out for repair).

MODEL 3013 SPECIFICATIONS:

Heavy Duty - 42 lbs, 110, 175, 245, 385 RPM. Cuts up to 4 1/2" diameter holes in 1 1/4" through 12" diameter pipe. 110 volts 10 amps, (220 Volts is available).

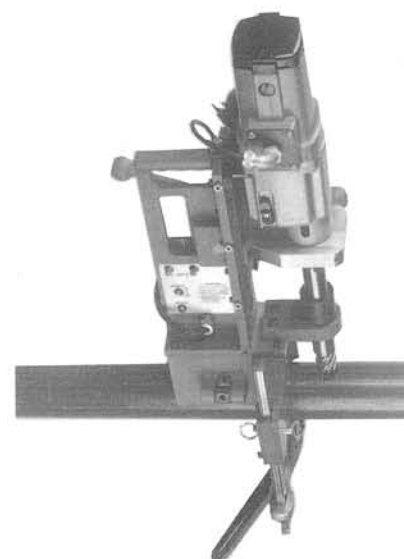
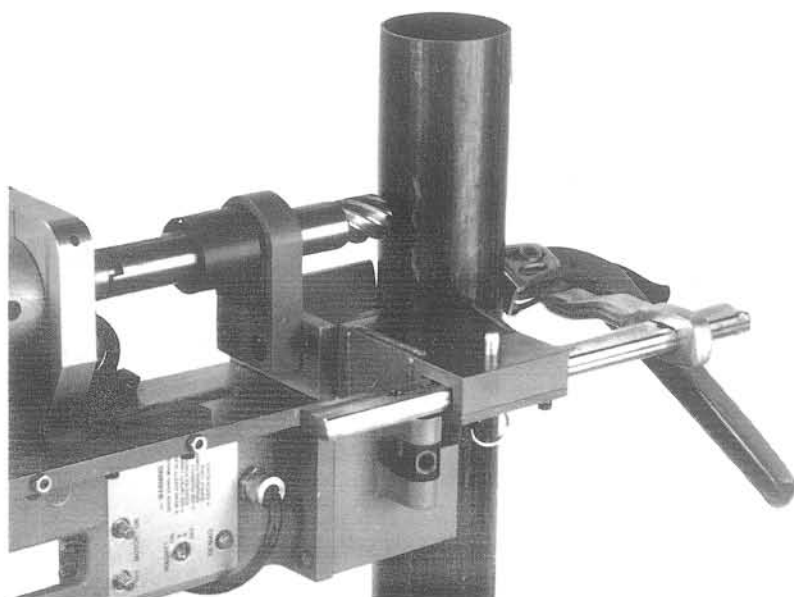
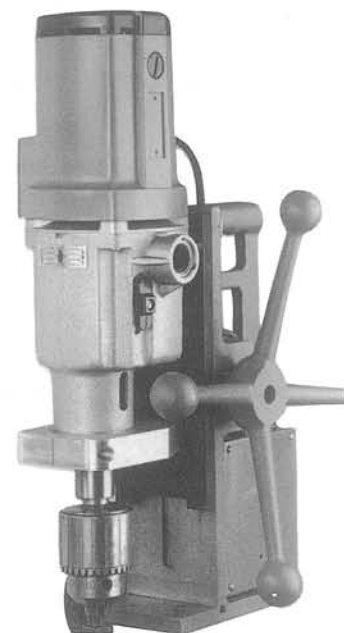
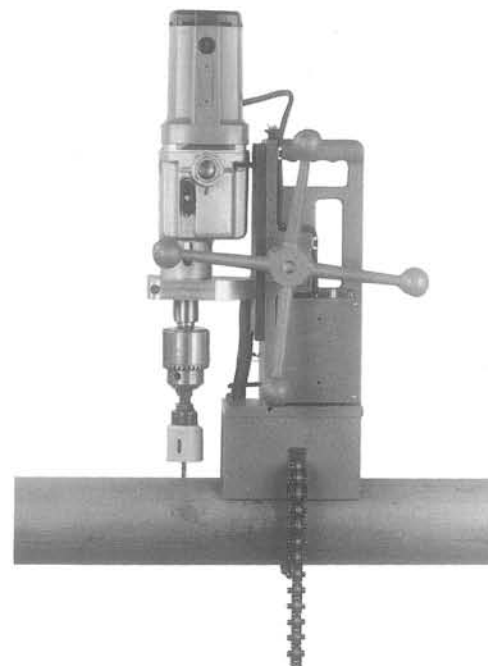

model 8100

Buck-on Machine

**Fast, accurate fitting
installation on 1", 1 1/4",
1 1/2" and 2" pipe.**

**Infinite Torque adjustment range
Easy to operate
Engineered for production work
No bushing boxes required**

The PACE BUCK-ON machine helps you improve productivity by bucking-on a wide variety of fittings quickly and accurately. It reduces the time you spend waiting for pipe and fittings to be joined. And that improves profitability.

Pace has streamlined the buck-on process with a new clutch design and universal cam chuck.

The new clutch allows an infinite range of adjustment for better results with any kind of pipe dope. The simpler clutch design also means greater reliability, eliminating costly downtime.

In addition, the universal cam chuck saves set-up time by eliminating the need for keys and box liners.

EASY TO OPERATE

To use the Pace Buck-on machine, you simply turn the knob until the indicator needle matches the prescribed pressure setting. Then place the fitting into the jaws, adjust the size with a hex key, slide the pipe in place and use the foot switch to clamp the pipe. The air system will clamp the pipe with the proper pressure automatically. It also assures safety by locking out the start cycle unless the pipe jaws are clamped.

BUILT FOR PRODUCTION WORK

Pace has engineered the Buck-on machine to stand up to the rigors of all day, every day use. Its electronic motor, cooling fan and filters are housed on a sturdy steel cabinet.

MODEL 8100 SPECIFICATIONS

Height: 43"
Width: 34"
Depth: 34"
Motor: 3 HP, 3 phase, 220V
Weight: 650 lbs.

STANDARD EQUIPMENT

Guard Comes ready to run as shown in picture.

OPTIONAL: 1/2"-3/4" Pipe inserts, Box Jaws



PACE **MACHINERY GROUP, INC.**

4N944 Old LaFox Road • P.O. Box 359 • Wasco, IL 60183
Phone: 1 630-377-1750 • Toll Free: 1 800-327-3552
Fax: 1 630-377-0274 • sales@pace-asp.com

Printed in the U.S.A.
Machine specifications subject to change without notice.